



Flygt 2071

Table of Contents

1 Introduction.....	2
1.1 Specially approved products.....	2
2 Product Description.....	3
2.1 Products included.....	3
2.2 The data plate.....	3
2.3 Product denomination.....	3
3 Spare Parts.....	5
3.1 Exploded view.....	5
3.2 List of parts.....	6

1 Introduction

Purpose of this manual

The purpose of this manual is to provide necessary information on spare parts and accessories order.

Disclaimer

Always use genuine Flygt parts. The use of other spare parts or accessories can invalidate any claims for warranty or compensation. Xylem does not take any responsibility for damages that are caused by the use of non-original parts. For more information, contact your local sales and service representative.

Data for ordering spare parts

The following information is needed for spare part orders:

- Serial number of the product
- Part number
- Quantity of bulk material, see * in tables

1.1 Specially approved products

Qualification of personnel

Only Xylem or Xylem-authorized service personnel may undertake repair work on specially approved products.

Dimensional accuracy inspection

Spare parts marked with (Ex) after the part number are subject to dimensional accuracy inspection when used in specially approved products.

2 Product Description

2.1 Products included

Pump model	Standard	EX	MSHA	Drainage	Sludge
2071.010	X			X	

2.2 The data plate

The data plate is a metal label that is located on the main body of the products. The data plate lists key product specifications. Specially approved products also have an approval plate.

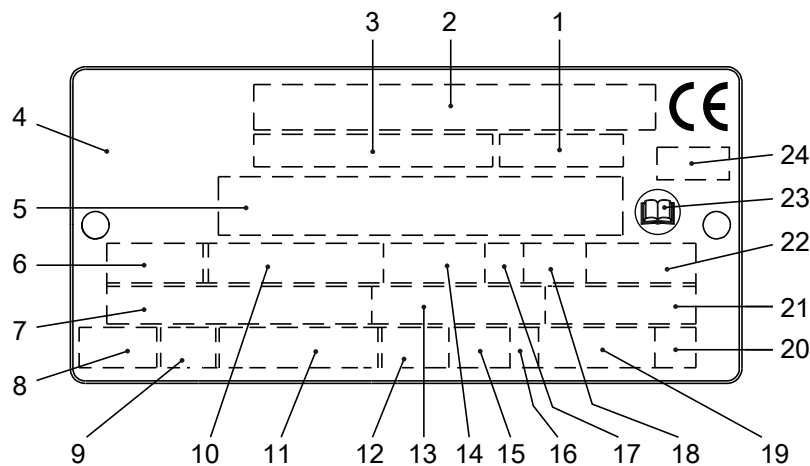

1. Curve code or Propeller code
2. Serial number
3. Product number
4. Country of origin
5. Additional information
6. Phase; type of current; frequency
7. Rated voltage
8. Thermal protection
9. Thermal class
10. Rated shaft power
11. International standard
12. Degree of protection
13. Rated current
14. Rated speed
15. Maximum submergence
16. Direction of rotation: L=left, R=right
17. Duty class
18. Duty factor
19. Product weight
20. Locked rotor code letter
21. Power factor
22. Maximum ambient temperature
23. Read installation manual
24. Notified body, only for EN-approved Ex products

Figure 1: The data plate

2.3 Product denomination

Reading instruction

In this section, code characters are illustrated accordingly:

X = letter

Y = digit

The different types of codes are marked up with a, b and c. Code parameters are marked up with numbers.

Codes and parameters

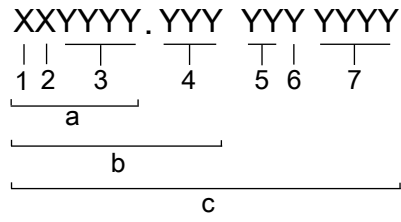

WS006265B

Type of Callout	Number	Indication
Type of code	a	Sales denomination
	b	Product code
	c	Serial number
Parameter	1	Hydraulic end
	2	Type of installation
	3	Sales code
	4	Version
	5	Production year
	6	Production cycle
	7	Running number

3 Spare Parts

3.1 Exploded view

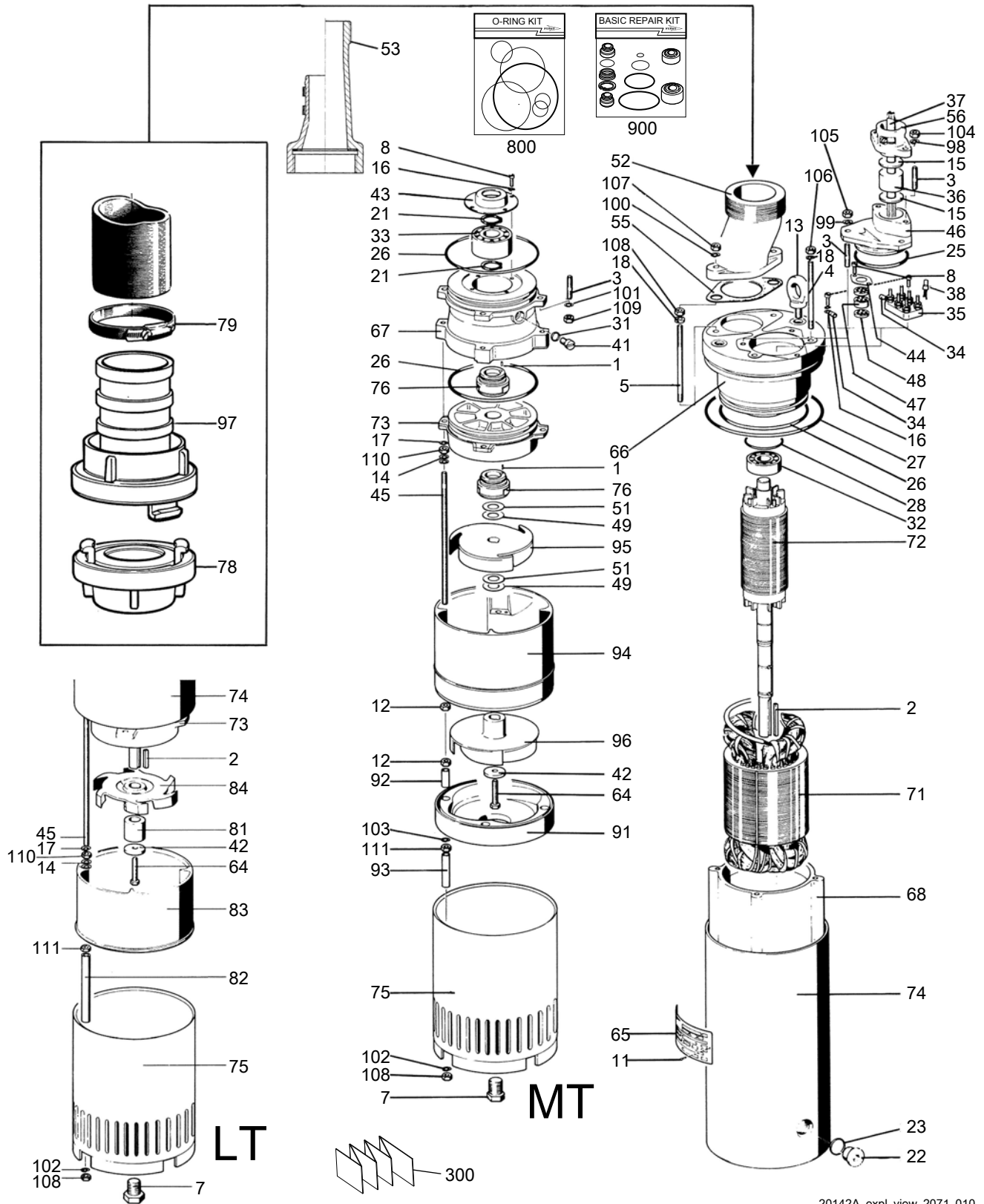

20142A_expl_view_2071_010

3.2 List of parts

Table 1: 2071

Pos. No	Part. No	Type	Denomination	Qty/Version
				010
1	80 52 06		Grooved pin	2
2	80 71 75		Parallel key 5X5X22-A4 LT B DN 75 Diffusor material: Polyurethane rubber (PU)	1
2	80 71 77		Parallel key 5X5X50-A4 LT B DN 75 Diffusor material: NBR MT B DN 50 Diffusor material: NBR MT B DN 50 Diffusor material: Polyurethane rubber (PU)	1
3	80 94 84		Stud M8X22-A2-70 No of cable entries: 1 (14)-16mm No of cable entries: 1 (12)-14mm No of cable entries: 1 (16)-18mm Cable entry No of cable entries: 1 (18)-20mm	7
3	80 94 84		Stud M8X22-A2-70 No of cable entries: 1 (14)-16mm No of cable entries: 1 (12)-14mm No of cable entries: 1 (16)-18mm No of cable entries: 1 (18)-20mm	2
4	80 94 99		Stud M8X90	2
5	80 95 02		Stud M8X105-A2-70	2
7	81 41 52		Hexagon head screw M12X20-A2-70	1
8	81 73 57		Slotted head screw M5X12-A4-70	Terminal board
8	81 73 57		Slotted head screw M5X12-A4-70	Terminal board
11	82 20 01		Tapping screw	2
12	82 23 32		Hexagon nut M8-A4-70	8
13	82 30 90		Lifting eye bolt M10	2
14	82 35 16		Plain washer 8.4X16X1.6-A2-140HV	8
15	82 40 84		Plain washer 14.5X35X2-A2-70	No of cable entries: 1 (12)-14mm
15	82 40 55		Plain washer 16.5X35X2-A2-70	No of cable entries: 1 (14)-16mm
15	82 40 57		Plain washer 18.5X35X2-A2-70	No of cable entries: 1 (16)-18mm
15	82 40 59		Plain washer 20.5X35X2-A2-70	No of cable entries: 1 (18)-20mm
15	82 40 60		Plain washer 22.5X35X2-A2-70	No of cable entries: 1 (20)-22mm
16	82 48 88		Spring washer DIN 127-B-5-A4	5
17	82 35 16		Plain washer 8.4X16X1.6-A2-140HV	4
18	82 50 30		Sealing washer	4
21	82 58 96		Retaining ring SGA 25	2
22	82 92 55		Plug	2
23	82 73 90		O-ring 19.2X3 NBR	2
23	82 72 95		O-ring 19.2X3 FPM	2
25	82 74 07		O-ring 74.2X5.7 NBR	1
25	82 80 84		O-ring 74.2X5.7 FPM	1
26	82 74 16		O-ring 119.3X5.7 NBR	3
26	82 81 72		O-ring 119.3X5.7 FPM	3
27	82 74 86		O-ring 164.3X5.7 NBR	1

Pos. No	Part. No	Type	Denomination	Qty/Version	
				010	
27	82 81 02		O-ring 164.3X5.7 FPM	1	
28	82 77 95		O-ring 52.5X3.0 NBR	1	
28	82 79 28		O-ring 52.5X3.0 FPM	1	
31	82 73 82		O-ring 10.3X2.4 NBR	2	
31	82 81 09		O-ring 10.3X2.4 FPM	2	
32	83 33 13		Ball bearing 20X52X15 MM	1	
33	83 30 15		Ball bearing 25X62X25.4	1	
34	83 42 83		Cable lug 0.5-1.5 MM2 M5	9	
34	83 42 83		Cable lug 0.5-1.5 MM2 M5	6	
34	83 43 04		Cable lug 1-2.5 MM2 M5	4	
34	83 43 04		Cable lug 1-2.5 MM2 M5	3	
34	83 43 24		Cable lug 2.5-6 MM2 M5	1	
34	83 43 24		Cable lug 2.5-6 MM2 M5	4	
34	83 42 83		Cable lug 0.5-1.5 MM2 M5	4	
34	83 43 02		Cable lug 6.1-10 MM2 M5	1	
34	83 43 24		Cable lug 2.5-6 MM2 M5	3	
34	83 43 61		Cable lug UL/CSA 0.50-1.65 MM2 M5	1	
34	83 43 04		Cable lug 1-2.5 MM2 M5	6	
34	83 43 04		Cable lug 1-2.5 MM2 M5	7	
34	83 43 24		Cable lug 2.5-6 MM2 M5	5	
35	555 43 00		Con.term.board unit	1	
36	84 35 59		Seal sleeve (12)-14 MM CR	No of cable entries: 1 (12)-14mm	1
36	84 35 32		Seal sleeve (14)-16 MM CR	No of cable entries: 1 (14)-16mm	1
36	84 35 33		Seal sleeve (16)-18 MM CR	No of cable entries: 1 (16)-18mm	1
36	84 35 34		Seal sleeve (18)-20 MM CR	No of cable entries: 1 (18)-20mm	1
36	84 35 35		Seal sleeve (20)-22 MM CR	No of cable entries: 1 (20)-22mm	1
37	94 20 42		Motor cable subcab 4G2.5	Power cable x 1 SUBCAB 4G2,5 12,50 - 13,50mm	*
37	94 17 23		Motor cable 3X2,5MM	Power cable x 1 Screened 3x2,5 13,50 - 14,90mm	*
37	94 20 43		Motor cable subcab 4G4	Power cable x 1 SUBCAB 4G4 16 - 17mm	*
37	94 20 61		Motor cable subcab 4G1.5+2X1.5	Power cable x 1 SUBCAB 4G1,5+2x1,5 15,50 - 16,50mm	*
37	94 19 90		Motor cable subcab S3X2.5+3X2.5/3+S(4X0.5)	Power cable x 1 SUBCAB S3x2,5+3x2,5/3+4x1,5 18,70 - 20mm	*
37	94 20 59		Motor cable subcab 4G2.5+2X1.5	Power cable x 1 SUBCAB 4G2,5+2x1,5 17 - 18mm	*
37	94 17 24		Motor cable SCREENED 6X2,5+2*1,5	Power cable x 1 Screened 6x2,5+2x1,5 18,10 - 19,90mm Star delta possible	*
37	94 20 82		Motor cable subcab 7G2.5+2X1.5	Power cable x 1 SUBCAB 7G2,5+2x1,5 20 - 23mm Star delta possible	*
37	94 21 06		Motor cable	Power cable x 1 SUBCAB 10AWG/ 3-2-1-GC 20,30 - 22,30mm	*

Pos. No	Part. No	Type	Denomination	Qty/Version
				010
38	83 44 24		Closed-end splice 3-6 (AWG 12-10)	1
38	83 42 62		Closed-end splice 0.33-0.82 (AWG 22-18)	2
38	83 44 24		Closed-end splice 3-6 (AWG 12-10)	3
41	303 44 02		Slotted head screw	2
42	303 45 03		Plain washer 8.4X30X5	1
43	342 70 01		Bearing cover	1
44	342 78 00		Supporting washer	2
45	342 82 01		Stud	4
46	342 87 00		Cover	1
			No of cable entries: 1 (14)-16mm	
			No of cable entries: 1 (12)-14mm	
			No of cable entries: 1 (16)-18mm	
			No of cable entries: 1 (18)-20mm	
46	514 85 00		Cover	1
			No of cable entries: 1 (20)-22mm	
47	342 92 01		Stator conductor ent 6 HOLES	1
47	342 92 03		Stator conductor ent 8 HOLES	1
47	342 92 02		Stator conductor ent 0 HOLES	1
48	342 93 00		Supporting washer	4
49	312 88 00		Washer 18.3X30X0.3	2
			MT B DN 50 Diffusor material: NBR	
			MT B DN 50 Diffusor material: Polyurethane rubber (PU)	
49	312 88 00		Washer 18.3X30X0.3	3
			MT B DN 50 Diffusor material: NBR	
			MT B DN 50 Diffusor material: Polyurethane rubber (PU)	
51	343 10 01		Washer 18.3X30X1.5	2
			MT B DN 50 Diffusor material: NBR	
			MT B DN 50 Diffusor material: Polyurethane rubber (PU)	
51	343 10 01		Washer 18.3X30X1.5	3
			MT B DN 50 Diffusor material: NBR	
			MT B DN 50 Diffusor material: Polyurethane rubber (PU)	
52	343 16 00		Discharge connection 2"	1
			DN 50 Hose	
52	343 18 00		Discharge connection ISO G2"	1
			DN 50 Thread : ISO G2A Outer Quick coupling: Storz	
52	343 18 01		Discharge connection 2-11 1/2 NPSM	1
			DN 50 Thread : NPSM 2-11 1/2 Outer	
52	343 17 00		Discharge connection 3"	1
			DN 75 Hose	
52	343 19 00		Discharge connection ISO G3"	1
			DN 75 Thread : ISO G3A Outer Quick coupling: Storz	
52	343 19 01		Discharge connection 3-8 NPSM	1
			DN 75 Thread : NPSM 3-8 Outer	
55	343 20 00		Gasket	1
56	394 77 00		Motor cable entr.uni	1
			No of cable entries: 1 (14)-16mm	
			No of cable entries: 1 (12)-14mm	
56	394 77 01		Motor cable entr.uni	1
			No of cable entries: 1 (16)-18mm	
			No of cable entries: 1 (18)-20mm	
56	254 03 06		Motor cable entry	1
			No of cable entries: 1 (20)-22mm	
64	425 43 00		Hexagon head screw	1

Pos. No	Part. No	Type	Denomination	Qty/Version
				010
65	630 68 00		Data plate USE 6306801 AS SPARE PART	1
66	463 01 00		Bearing housing	1
67	515 99 00		Bearing housing	1
68	463 03 00		Stator housing	1
71	463 08 12		Stator 13-12-2a	1
			3-phase 60 Hz 2-poles 440V-460V YSER 220V-230V Y// P1=4,20KW Max ambient temp=70 DC Thermal contact	
			3-phase 60 Hz 2-poles 440V-460V YSER 220V-230V Y// P2=4,50kW/6hp Max ambient temp=40 DC Thermal contact	
			1-phase 60 Hz 2-poles 230V P2=3,10kW/4,10hp Max ambient temp=40 DC Thermal contact	
71	463 08 34		Stator 13-12-2a	1
			3-phase 50 Hz 2-poles 380V-400V Y 220V-230V D P2=3kW Max ambient temp=40 DC Thermal contact	
			3-phase 60 Hz 2-poles 440V-460V Y 260V D P1=4,20KW Max ambient temp=70 DC Thermal contact	
			3-phase 50 Hz 2-poles 380V-400V Y 220V-230V D P1=3,50KW Max ambient temp=70 DC Thermal contact	
			3-phase 60 Hz 2-poles 440V-460V Y 260V D P2=4,50kW/6hp Max ambient temp=40 DC Thermal contact	
71	463 08 38		Stator 13-12-2a	1
			3-phase 50 Hz 2-poles 660V-690V Y 380V-400V D P2=3kW Max ambient temp=40 DC Thermal contact	
			3-phase 60 Hz 2-poles 440V-460V D P1=4,20KW Max ambient temp=70 DC Thermal contact	
			3-phase 50 Hz 2-poles 660V-690V Y 380V-400V D P1=3,50KW Max ambient temp=70 DC Thermal contact	
			3-phase 60 Hz 2-poles 440V-460V D P2=4,50kW/6hp Max ambient temp=40 DC Thermal contact	
71	463 08 44		Stator 13-12-2a	1
			3-phase 50 Hz 2-poles 400V-440V D P2=3kW Max ambient temp=40 DC Thermal contact	
			3-phase 50 Hz 2-poles 400V-440V D P1=3,50KW Max ambient temp=70 DC Thermal contact	

Pos. No	Part. No	Type	Denomination	Qty/Version	
				010	
71	463 08 52		Stator 13-12-2a	3-phase 50 Hz 2-poles 500V-550V D P2=3kW Max ambient temp=40 DC Thermal contact 3-phase 60 Hz 2-poles 575V-600V D P1=4,20KW Max ambient temp=70 DC Thermal contact 3-phase 50 Hz 2-poles 500V-550V D P1=3,50KW Max ambient temp=70 DC Thermal contact 3-phase 60 Hz 2-poles 575V-600V D P2=4,50kW/6hp Max ambient temp=40 DC Thermal contact	1
71	463 08 29		Stator 13-12-2a	3-phase 60 Hz 2-poles 380V Y 220V-230V D P1=4,20KW Max ambient temp=70 DC Thermal contact 3-phase 60 Hz 2-poles 380V Y 220V-230V D P2=4,50kW/6hp Max ambient temp=40 DC Thermal contact	1
72	463 11 00		Shaft unit		1
73	463 12 00		Oil housing coated	MT B DN 50 Diffusor material: NBR LT B DN 75 Diffusor material: NBR	1
73	463 12 01		Oil housing coated U	LT B DN 75 Diffusor material: Polyurethane rubber (PU) MT B DN 50 Diffusor material: Polyurethane rubber (PU)	1
74	463 13 00		Outer casing		1
75	463 14 02		Strainer unit	Standard	1
75	463 14 04		Strainer unit	Option	1
76	720 75 01		Mechanical seal WCCR/WCCR FPM		2
78	83 18 24		Coupling part	DN 50 Thread : ISO G2A Outer Quick coupling: Storz	1
78	83 18 46		Coupling part	DN 75 Thread : ISO G3A Outer Quick coupling: Storz	1
79	84 55 53		Hose clamp OD=40-60 MM	Option	2
79	84 55 55		Hose clamp OD=60-80 MM	Option	2
81	343 14 01		Sleeve 18X30X28		1
82	343 23 01		Pipe		4
83	463 04 00		Diffuser coat.	LT B DN 75 Diffusor material: NBR	1
83	463 04 01		Diffuser coat.	LT B DN 75 Diffusor material: Polyurethane rubber (PU)	1
84	681 22 00		Impeller	211 LT 50Hz 3-phase Max ambient temp=40 DC	1
84	681 22 01		Impeller	212 LT 50Hz 3-phase Max ambient temp=70 DC 212 LT 60Hz 3-phase Max ambient temp=40 DC	1

Pos. No	Part. No	Type	Denomination	Qty/Version
				010
84	681 22 02		Impeller 216 LT 60Hz 3-phase Max ambient temp=70 DC 216 LT 60Hz 1-phase Max ambient temp=40 DC	1
91	342 80 00		Diffuser coat. MT B DN 50 Diffusor material: NBR	1
91	342 80 01		Diffuser coat. MT B DN 50 Diffusor material: Polyurethane rubber (PU)	1
92	342 83 00		Sleeve 10X12X24	4
93	343 23 02		Pipe	4
94	463 17 00		Diffuser coat. MT B DN 50 Diffusor material: NBR	1
94	463 17 01		Diffuser coat. MT B DN 50 Diffusor material: Polyurethane rubber (PU)	1
95	681 23 00		Impeller 231 MT 50Hz 3-phase Max ambient temp=40 DC 231 MT 60Hz 3-phase Max ambient temp=40 DC	1
95	681 23 02		Impeller 236 MT 60Hz 3-phase Max ambient temp=70 DC 236 MT 60Hz 3-phase Max ambient temp=40 DC 236 MT 60Hz 1-phase Max ambient temp=40 DC	1
95	485 98 03		Impeller 241 MT 50Hz 3-phase Max ambient temp=40 DC Mtrl. Stainless steel (ASTM 329)	1
95	485 98 04		Impeller 242 MT 50Hz 3-phase Max ambient temp=70 DC Mtrl. Stainless steel (ASTM 329) 242 MT 60Hz 3-phase Max ambient temp=40 DC Mtrl. Stainless steel (ASTM 329)	1
95	485 98 05		Impeller 246 MT 60Hz 3-phase Max ambient temp=70 DC Mtrl. Stainless steel (ASTM 329) 246 MT 60Hz 1-phase Max ambient temp=40 DC Mtrl. Stainless steel (ASTM 329)	1
96	681 24 00		Impeller 231 MT 50Hz 3-phase Max ambient temp=40 DC 231 MT 60Hz 3-phase Max ambient temp=40 DC	1
96	681 24 02		Impeller 236 MT 60Hz 3-phase Max ambient temp=70 DC 236 MT 60Hz 3-phase Max ambient temp=40 DC 236 MT 60Hz 1-phase Max ambient temp=40 DC	1
96	485 99 03		Impeller 241 MT 50Hz 3-phase Max ambient temp=40 DC Mtrl. Stainless steel (ASTM 329)	1

Pos. No	Part. No	Type	Denomination	Qty/Version
				010
96	485 99 04		Impeller 242 MT 50Hz 3-phase Max ambient temp=70 DC Mtrl. Stainless steel (ASTM 329)	1
			242 MT 60Hz 3-phase Max ambient temp=40 DC Mtrl. Stainless steel (ASTM 329)	
96	485 99 05		Impeller 246 MT 60Hz 3-phase Max ambient temp=70 DC Mtrl. Stainless steel (ASTM 329)	1
			246 MT 60Hz 1-phase Max ambient temp=40 DC Mtrl. Stainless steel (ASTM 329)	
97	83 18 25		Coupling part Option	1
97	83 18 28		Coupling part Option	1
97	83 19 30		Coupling part Option	1
97	83 19 31		Coupling part Option	1
97	83 92 01		Check valve 2" PN16 Option	1
97	83 92 02		Check valve 3" PN16 Option	1
97	342 58 00		Suction connect.unit 2" Option	1
97	342 58 01		Suction connection ISO G2-A Option	1
97	342 58 02		Suction connection NPSM 2-11 1/2 Option	1
97	342 58 04		Suction connection ISO G3-A Option	1
97	342 58 05		Suction connection NPSM 3-8 Option	1
97	342 59 00		Suction connection 2" Option	1
97	342 60 00		Suction connection R2" Option	1
97	342 60 01		Suction connection NPSM 2-11 1/2 Option	1
97	343 21 00		Suction connection 3" Option	1
97	343 22 00		Suction connection R3" Option	1
97	343 22 01		Suction connection NPSM 3-8 Option	1
98	82 35 16		Plain washer 8.4X16X1.6-A2-140HV	2
99	82 35 16		Plain washer 8.4X16X1.6-A2-140HV	3
100	82 35 16		Plain washer 8.4X16X1.6-A2-140HV	2
101	82 35 16		Plain washer 8.4X16X1.6-A2-140HV	4
102	82 35 16		Plain washer 8.4X16X1.6-A2-140HV	4
103	82 35 16		Plain washer 8.4X16X1.6-A2-140HV	4
104	82 23 32		Hexagon nut M8-A4-70	2
105	82 23 32		Hexagon nut M8-A4-70	3
106	82 23 32		Hexagon nut M8-A4-70	4
107	82 23 32		Hexagon nut M8-A4-70	2
108	82 23 32		Hexagon nut M8-A4-70	4
109	82 23 32		Hexagon nut M8-A4-70	4
110	82 23 32		Hexagon nut M8-A4-70	4
111	82 23 32		Hexagon nut M8-A4-70	8
300	775 17 00		Connection plate	1
800	723 55 00		O-ring kit NBR	1
800	723 56 00		O-ring kit FPM	1

Pos. No	Part. No	Type	Denomination	Qty/Version
				010
801	429 90 00		Zinc anode kit	1
810	514 15 04		Rebuilding kit LT Option	1
810	514 15 05		Rebuilding kit MT Option	1
900	601 90 16		Basic repair kit	1
901	90 17 52		Oil ISO VG 32	*



ООО «Бауманс Груп» - официальный партнер фирмы Flygt в России.

Тел: +7 495 121 49 50

Эл. почта: info@baumgroup.ru

Сайт: www.baumgroup.ru